

# ESTATES OF ROYAL PALM BEACH PLAT 4

LYING IN THE NORTHEAST ONE-QUARTER OF SECTION 34, TOWNSHIP 43 SOUTH, RANGE 41 EAST, VILLAGE OF ROYAL PALM BEACH, PALM BEACH COUNTY, FLORIDA

### CURVE TABLE

C1	R=125'	CA=65°24'29"	L=142.70'	LCB=N56°08'37"W	CHD=135.07'
C2	R=100'	CA=65°24'29"	L=114.16'	LCB=S56°06'37"E	CHD=108.06'
C3	R=75'	CA=65°24'29"	L=85.62'	LCB=S56°06'37"E	CHD=81.04'
C4	R=75'	CA=65°04'53"	L=85.19'	LCB=S55°56'49"E	CHD=80.68'
C5	R=100'	CA=65°04'53"	L=113.59'	LCB=S55°56'49"E	CHD=107.58'
C6	R=100'	CA=22°39'45"	L=39.55'	LCB=S34°44'15"E	CHD=39.30'
C7	R=100'	CA=42°25'08"	L=74.04'	LCB=S67°16'42"E	CHD=72.36'
C8	R=25'	CA=48°11'23"	L=21.03'	LCB=S00°41'19"W	CHD=20.41'
C9	R=50'	CA=142°26'59"	L=124.31'	LCB=S46°26'29"E	CHD=94.68'
C10	R=25'	CA=43°18'30"	L=18.88'	LCB=N83°58'17"E	CHD=18.44'
C11	R=125'	CA=14°05'48"	L=30.75'	LCB=S81°26'22"E	CHD=30.68'
C12	R=175'	CA=35°04'03"	L=107.11'	LCB=N73°58'42"E	CHD=105.44'
C13	R=200'	CA=35°04'03"	L=122.41'	LCB=N73°58'42"E	CHD=120.51'
C14	R=225'	CA=35°04'03"	L=137.71'	LCB=N73°58'42"E	CHD=135.57'
C15	R=605'	CA=10°18'42"	L=108.88'	LCB=N51°17'20"E	CHD=108.74'
C16	R=630'	CA=10°18'42"	L=113.38'	LCB=N51°17'20"E	CHD=113.23'
C17	R=655'	CA=10°18'42"	L=117.88'	LCB=N51°17'20"E	CHD=117.72'



GRAPHIC SCALE  
(IN FEET)



SHEET 3 of 3

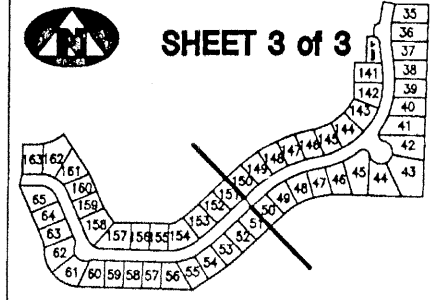

SHEET 2 of 3

### LEGEND:

- (R) DENOTES A RADIAL LINE
- C/L DENOTES A CENTERLINE
- PC DENOTES POINT OF CURVATURE
- PT DENOTES POINT OF TANGENCY
- EC DENOTES END OF CURVE
- PRC DENOTES POINT OF REVERSE CURVATURE
- POCC DENOTES POINT OF COMPOUND CURVATURE
- UE DENOTES UTILITY EASEMENT
- DE DENOTES DRAINAGE EASEMENT
- DB DENOTES DEED BOOK
- LAE DENOTES LIMITED ACCESS EASEMENT
- R DENOTES RADIUS DISTANCE
- ARC DENOTES ARC LENGTH DISTANCE
- CA DENOTES CENTRAL ANGLE
- LCB DENOTES LONG CHORD BEARING
- CHD DENOTES CHORD DISTANCE
- POB DENOTES POINT OF BEGINNING
- POC DENOTES POINT OF COMMENCEMENT
- ORB DENOTES OFFICIAL RECORDS BOOK
- PB DENOTES PLAT BOOK NUMBER
- PN DENOTES PAGE NUMBER
- PCPM DENOTES PERMANENT CONTROL POINT
- PCP DENOTES PERMANENT CONTROL POINT MONUMENT
- MONUMENT (NO. 2424)
- PCP DENOTES A FOUND PERMANENT REFERENCE MONUMENT (NO. 2424)
- PCP DENOTES A SET PERMANENT REFERENCE MONUMENT (NO. 2424)
- PCP DENOTES A FOUND PERMANENT CONTROL POINT (NO. 2424)
- PCP DENOTES A FOUND PERMANENT CONTROL POINT (NO. 2424)
- PCP DENOTES LOT CORNER MONUMENT POSITION

### SURVEYOR'S NOTES:

- THE BASE BEARING, (BB), IS NORTH 88°29'16" WEST ALONG THE SOUTH LINE OF LOTS 65 THROUGH 69 AS SHOWN HEREON.
- IN THOSE INSTANCES WHERE UTILITY/DRAINAGE STRUCTURES ARE CONSTRUCTED IN CONFLICT WITH THE PLATTED PERMANENT CONTROL POINTS (P.C.P.) POSITION, STRADDLERS MONUMENTED AS PERMANENT CONTROL POINTS WILL BE SET TO REFERENCE THE PLATTED P.C.P. POSITION.
- LINE WHICH INTERSECT CURVES ARE NOT RADIAL UNLESS OTHERWISE NOTED.
- THIS INSTRUMENT WAS PREPARED BY WM. R. VAN CAMPEN, P.S.M. IN AND FOR THE OFFICES OF BENCH MARK LAND SURVEYING AND MAPPING, INC., 4152 WEST BLUE HERON BOULEVARD, SUITE 121, RIVIERA BEACH, FLORIDA.

**BENCH MARK** LAND SURVEYING & MAPPING, INC.  
 4152 W. BLUE HERON BOULEVARD • SUITE 121  
 RIVIERA BEACH • FLORIDA 33404  
 PHONE: (561) 848-2102 • L.B. 2171 • FAX: (561) 844-9859  
 EMAIL: bmlsm@aol.com WEB: http://members.aol.com/bmlsmr

RECORD PLAT

ESTATES OF ROYAL PALM BEACH PLAT 4

OWN	W.H.I.	P.B.	DATE	02/01/00	WO.#	P3.P4
CKD	W.V.C.	FILE	PLAT	4	SCALE	1" = 50'
			SHEET 2 OF 3			

